

AIR PREPARATION UNITS

PRECISION REGULATOR - series

Kushako

Precision Regulator details :

Features :

- Precise pressure control
- Characteristics such as flow characteristic , pressure characteristic and repeatability are superior compared with standard regulators
- Excellent relief flow characteristics is available .
- Suitable for panel & modular mountings.
- Diaphragm operated, relieving type (Exhaust)
- Clamp and pressure gauge can be mounted either in the front or the back

Applications

- Some of the applications
- Manufacturers of air gauging equipment
- Medical equipments , Leak testing equipment
- Polishing machinery , Web tensioning
- Measuring machines
- Ink or paint, robotics spraying systems ,
- Tank blanketing and many....



Technical Specifications:

Model	PRS-2014
Medium	Compressed, Filtered, Non lubricated air
Port Size	G1/4 BSP (F)
Pressure gauge port size	G1/8 BSP (F)
Maximum supply pr. (bar)	10
minimum supply pr. (bar)	+0.5
Regulating pr. range (bar)	0 - 2, 0 - 4, 0 - 7, 0 - 10 (Standard)
Sensitivity	Within 0.2% of full span ²
Repeatability	Within ±0.5% of full span ²
Air consumption (lts / min) ³	6
Ambient / Medium temp.	5° - 60° C
Installation	Any position
Materials of construction	Aluminium, Brass, Steel, SS, Celcon, NBR
Optional accessories	Clamp, Modular mounting kit, Pr gauge
Weight (Kg)	0.314

Supply pressure 10 bar, Air is being exhausted to the atmosphere .

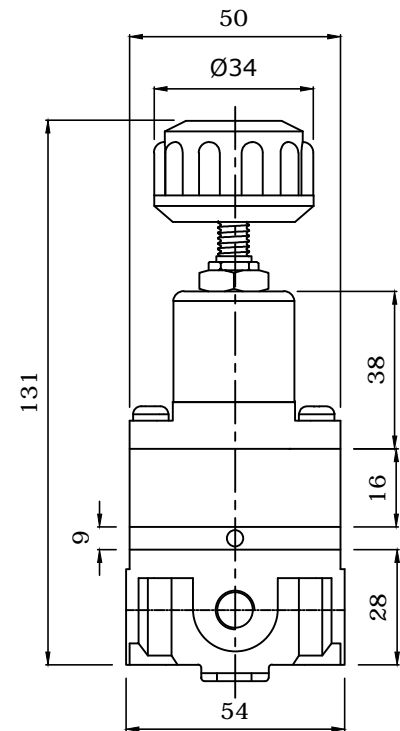

Precautions :

- If the supply pressure line contains drainage or dirt, etc. the disc can become clogged leading to malfunction , and therefore , in addition to an air filter be sure to use mist separator.
- Do not use a precision regulator outside the range of its specifications as this can cause failure
- When mounting is performed , make connections while confirming port indications
- Air is normally released from the bleed hole (the hole on the side of the body's mid -section) This is necessary consumption of air based on the construction of the precision regulator, and is not an abnormality
- Make sure to tighten the lock nut after pressure adjustment .



Manufactured by :

Kushako India

Office : 490, Narayan Peth, Opp. Pune Marathi Granthalaya, Pune - 411030. (Maharashtra), Website : www.kushakoindia.com

Works : Sr.No. 25/1A, Village Nanded, Sinhgad Road, Tal - Haveli, Dist. Pune - 411041

Tel. No : 901169077 / 7620674777

E-mail : kushako.india@gmail.com / kushakoindia1992@gmail.com

Kushako